

**FIELD REPORT**

Project: Cameron Commercial Client: HMD Date: 08/07/23  
City: Cameron Forman: Ken Contractor: OS&S  
Temperature: 91 Weather Conditions: Partly Cloudy Number of Trips: 1  
Personnel: Jon A Notified Ken of OS&S of results  
1<sup>st</sup> Trip Arrived: 12:30 pm Left: 4:00 pm 2<sup>nd</sup> Trip Arrived: \_\_\_\_\_ Left: \_\_\_\_\_

**REMARKS**

TME arrived onsite as requested. Tech observed Ken with OS&S grading onsite. Tech met with foreman to discuss the proofroll plan and what needed to be done to site before proof roll. Tech conducted proof roll with contractor following behind a loaded 3 axle. Tech proof rolled all available area that was not covered by equipment or material (see site plan illustration). Tech did not observe any significant movement. Tech did observe minor surface rutting due to the Sandy material being wetted down by the contractor to pack it in more effectively. Contractor will contact TME to schedule proof roll before paving.



Signature:

TME's presence on site is to perform specific services limited to that scheduled by others based on the understanding of our agreement with our client. This report is not an acceptance or approval of site activities. Test results and inspections are representative of our observations only while onsite at that specific time and location and may vary at other locations. The frequency of testing is based on timely scheduling of work by others and properly conveying progress of work in progress. At no time will TME be responsible for Safety considerations for other parties on the site.

Project Number:

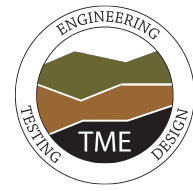

### FIELD REPORT ATTACHMENTS

Project: **Cameron Commercial** Client: **HMD**

Date: **08/07/23**

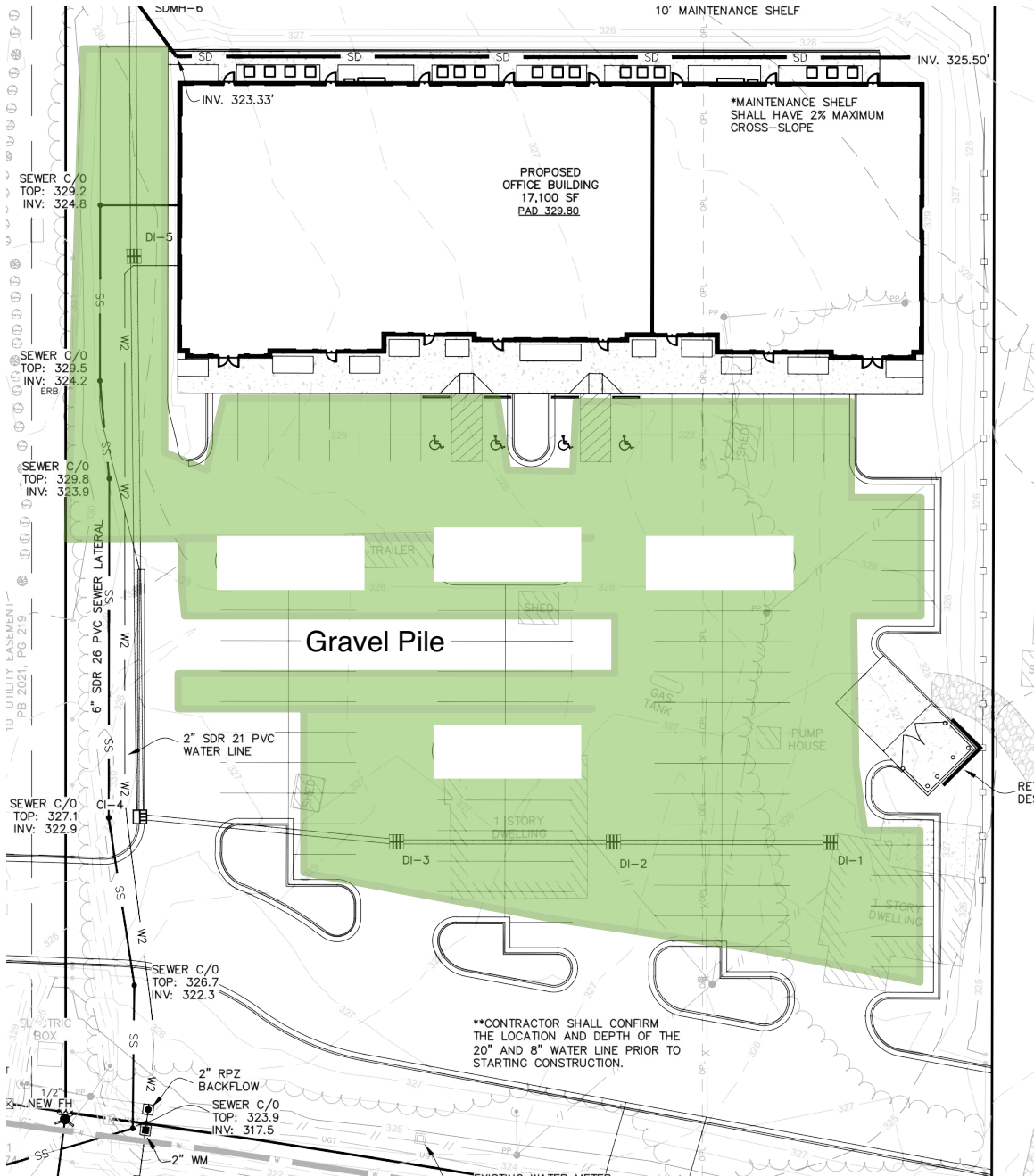

All locations should be considered approximate and were not surveyed.